

# DRAFT

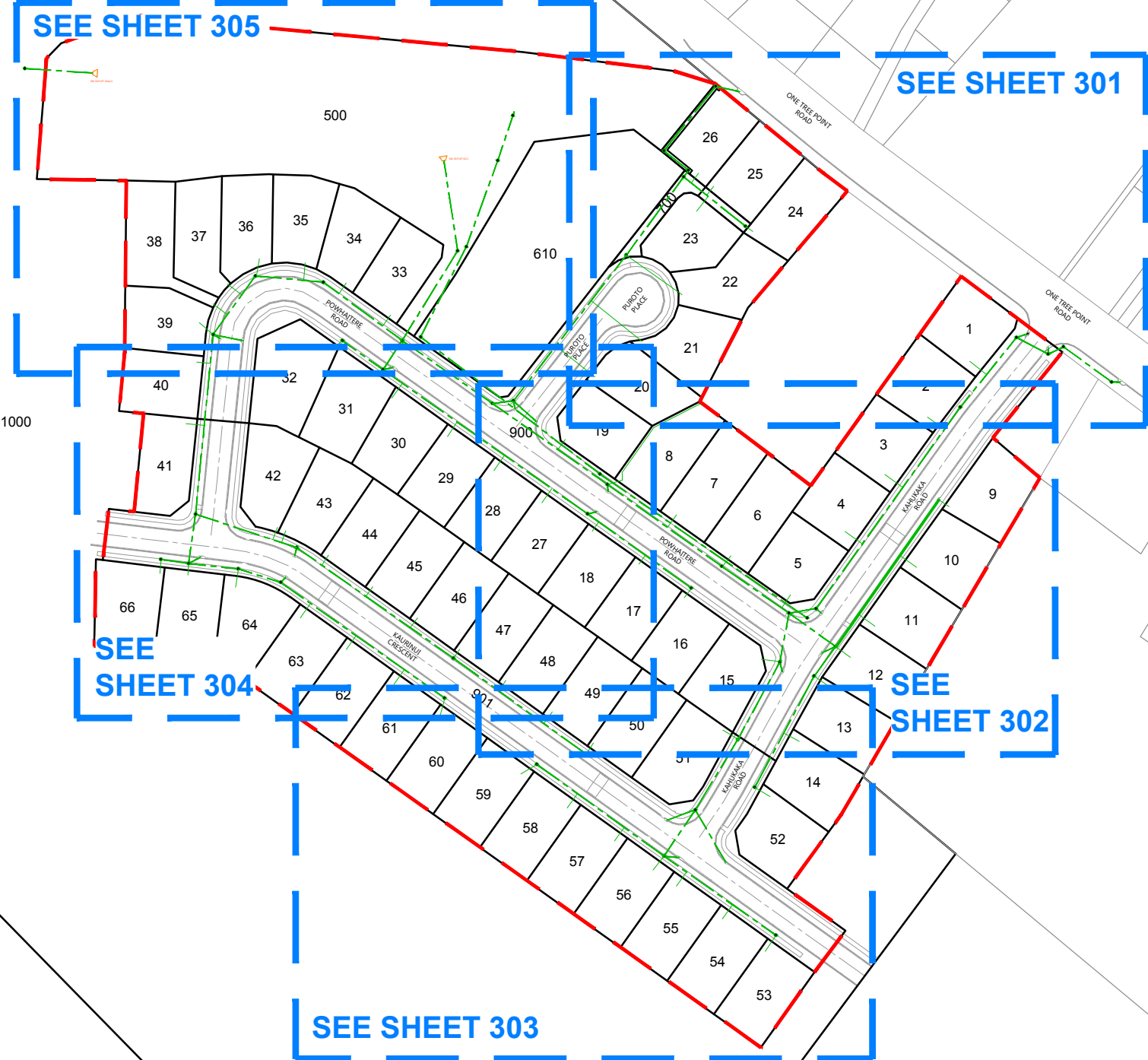

**LEGEND**

STORMWATER MANHOLE	
STORMWATER CESSPIT	CP 5 LL=8.07
STORMWATER DOUBLE CESSPIT	DCP LL=8.07
NEW STORMWATER	
LOT CONNECTION	
STAGE BOUNDARY	

- NOTES**
- ALL WORKS AND MATERIALS COMPLY WITH WDC STANDARDS FOR ENGINEERING DESIGN AND CONSTRUCTION.
  - ALL PIPE BEDDING COMPLIES WITH WDC STANDARDS
  - ALL PIPE CROSSINGS UNDER ROADS AND ACCESSWAYS HAVE BEEN HARDFILL BACKFILLED.
  - LOT BOUNDARIES ARE SUBJECT TO FINAL SURVEY.
  - ASBUILT DATA HAS BEEN SOURCED FROM A COMBINATION OF WOODS SURVEY MEASURED DATA AND CONTRACTOR RECEIVED DATA.

I certify that these As-built Plans are an accurate record of the works undertaken and that:

- The coordinates (X,Y) are in terms of NZTM on NZGD2000
- The Levels (Z) are in terms of One Tree Point 1964 (MSL) LINZ datum

Signed: \_\_\_\_\_  
Registered Professional Surveyor

Date: 16/05/2018

Name: ROWAN HALLAM

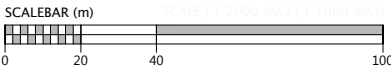

REVISION DETAILS	INT	DATE	SURVEYED	NSC
1 DRAFT ISSUE	NSC	17/05/18	DESIGNED	NSC
			DRAWN	NSC
			CHECKED	MRH
			APPROVED	MRH

ONE TREE POINT ROAD  
ONE TREE POINT  
NORTHLAND  
[WOODS.CO.NZ](http://WOODS.CO.NZ)



**THE LANDING @ MARSDEN, ONE TREE POINT  
STAGES 1-2  
STORMWATER**



STATUS	ISSUED FOR INFORMATION	REV
SCALE	1:2000 @ A3	1
COUNCIL	WHANGAREI DISTRICT COUNCIL	
DWG NO	31013-01-300-AB	





DRAFT

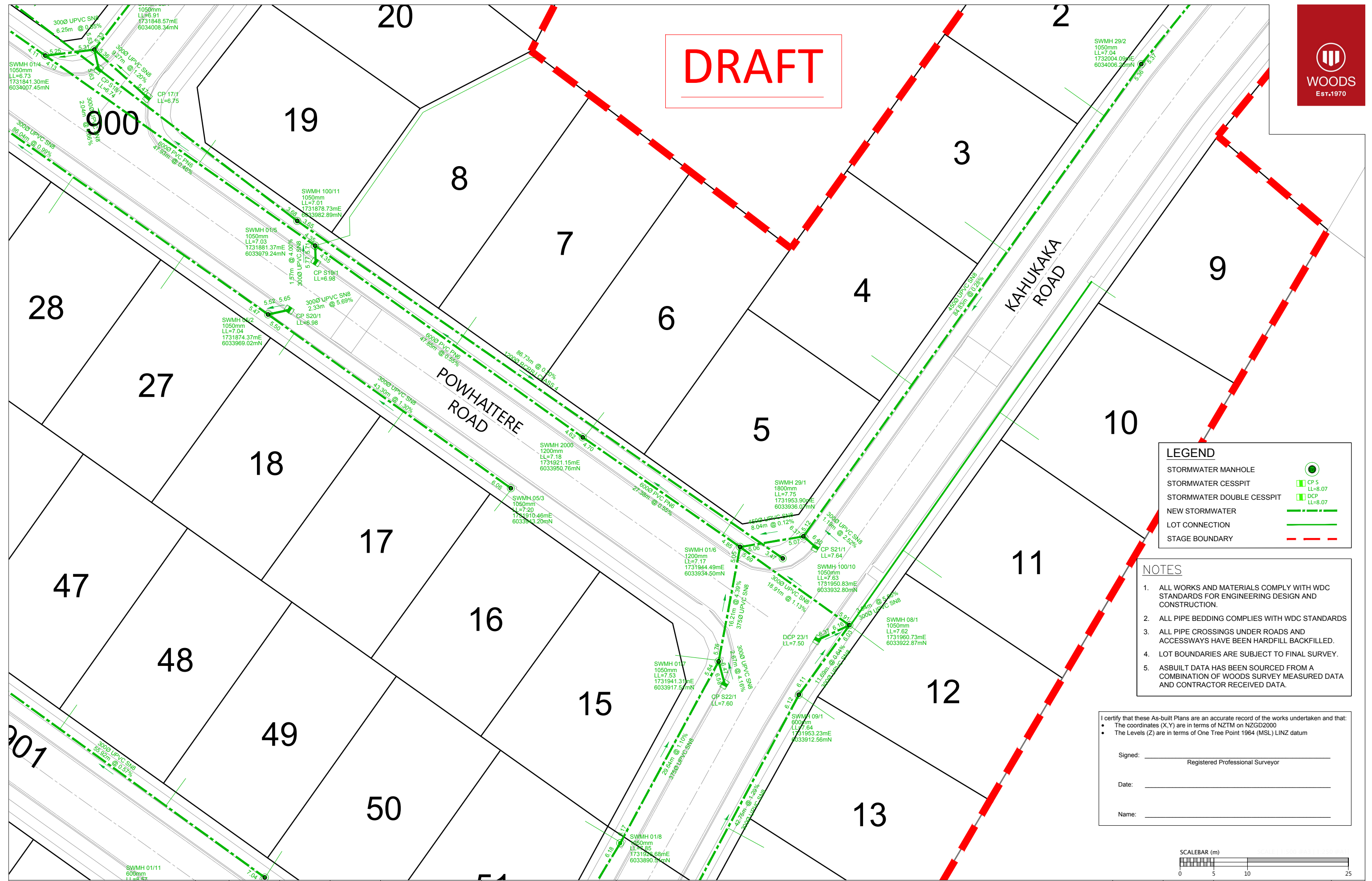

**LEGEND**

STORMWATER MANHOLE	
STORMWATER CESSPIT	
STORMWATER DOUBLE CESSPIT	
NEW STORMWATER	
LOT CONNECTION	
STAGE BOUNDARY	

- NOTES**
1. ALL WORKS AND MATERIALS COMPLY WITH WDC STANDARDS FOR ENGINEERING DESIGN AND CONSTRUCTION.
  2. ALL PIPE BEDDING COMPLIES WITH WDC STANDARDS
  3. ALL PIPE CROSSINGS UNDER ROADS AND ACCESSWAYS HAVE BEEN HARDFILL BACKFILLED.
  4. LOT BOUNDARIES ARE SUBJECT TO FINAL SURVEY.
  5. ASBUILT DATA HAS BEEN SOURCED FROM A COMBINATION OF WOODS SURVEY MEASURED DATA AND CONTRACTOR RECEIVED DATA.

I certify that these As-built Plans are an accurate record of the works undertaken and that:

- The coordinates (X, Y) are in terms of NZTM on NZGD2000
- The Levels (Z) are in terms of One Tree Point 1964 (MSL) LINZ datum

Signed: \_\_\_\_\_  
Registered Professional Surveyor

Date: \_\_\_\_\_

Name: \_\_\_\_\_

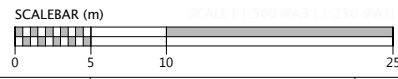

REVISION DETAILS	INT	DATE	SURVEYED	NSC
1 DRAFT ISSUE	NSC	17/05/18	DESIGNED	NSC
			DRAWN	NSC
			CHECKED	MRH
			APPROVED	MRH

ONE TREE POINT ROAD  
ONE TREE POINT  
NORTHLAND



THE LANDING @ MARSDEN, ONE TREE POINT  
STAGES 1-2  
STORMWATER

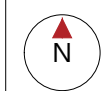

STATUS	ISSUED FOR INFORMATION	REV
SCALE	1:500 @ A3	1
COUNCIL	WHANGAREI DISTRICT COUNCIL	
DWG NO	31013-01-302-AB	



**LEGEND**

STORMWATER MANHOLE	
STORMWATER CESSPIT	CP 5 LL=8.07
STORMWATER DOUBLE CESSPIT	DCP LL=8.07
NEW STORMWATER	
LOT CONNECTION	
STAGE BOUNDARY	

- NOTES**
1. ALL WORKS AND MATERIALS COMPLY WITH WDC STANDARDS FOR ENGINEERING DESIGN AND CONSTRUCTION.
  2. ALL PIPE BEDDING COMPLIES WITH WDC STANDARDS
  3. ALL PIPE CROSSINGS UNDER ROADS AND ACCESSWAYS HAVE BEEN HARDFILL BACKFILLED.
  4. LOT BOUNDARIES ARE SUBJECT TO FINAL SURVEY.
  5. ASBUILT DATA HAS BEEN SOURCED FROM A COMBINATION OF WOODS SURVEY MEASURED DATA AND CONTRACTOR RECEIVED DATA.

I certify that these As-built Plans are an accurate record of the works undertaken and that:

- The coordinates (X,Y) are in terms of NZTM on NZGD2000
- The Levels (Z) are in terms of One Tree Point 1964 (MSL) LINZ datum

Signed: \_\_\_\_\_  
Registered Professional Surveyor

Date: 16/05/2018

Name: \_\_\_\_\_

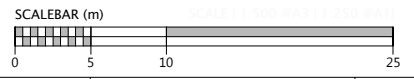

REVISION DETAILS	INT	DATE	SURVEYED	NSC
1 DRAFT ISSUE	NSC	17/05/18	DESIGNED	
			DRAWN	NSC
			CHECKED	MRH
			APPROVED	MRH

ONE TREE POINT ROAD  
ONE TREE POINT  
NORTHLAND



**THE LANDING @ MARSDEN, ONE TREE POINT  
STAGES 1-2  
STORMWATER**

STATUS	ISSUED FOR INFORMATION	REV
SCALE	1:500 @ A3	1
COUNCIL	WHANGAREI DISTRICT COUNCIL	
DWG NO	31013-01-303-AB	

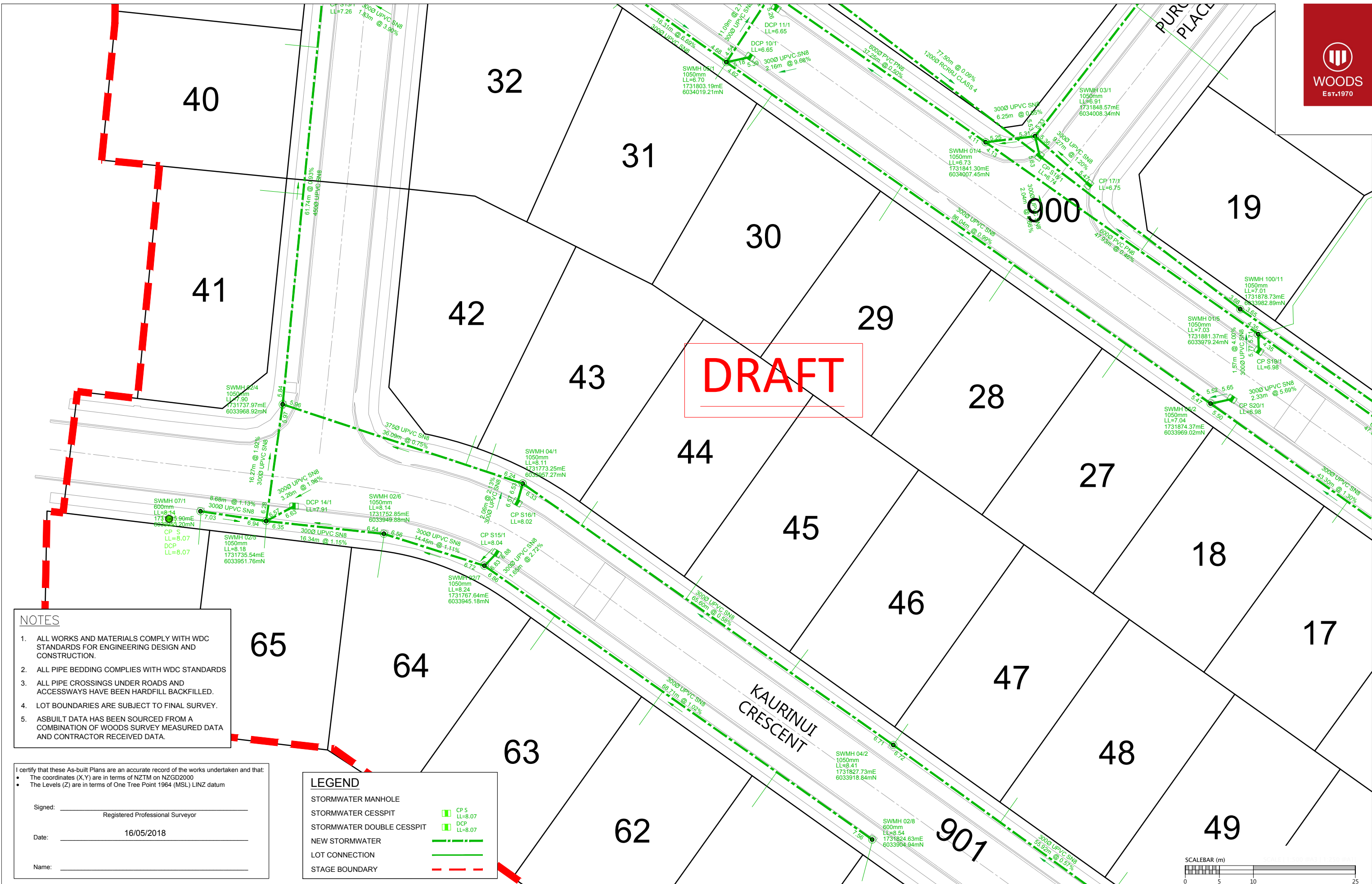

- NOTES**
1. ALL WORKS AND MATERIALS COMPLY WITH WDC STANDARDS FOR ENGINEERING DESIGN AND CONSTRUCTION.
  2. ALL PIPE BEDDING COMPLIES WITH WDC STANDARDS
  3. ALL PIPE CROSSINGS UNDER ROADS AND ACCESSWAYS HAVE BEEN HARDFILL BACKFILLED.
  4. LOT BOUNDARIES ARE SUBJECT TO FINAL SURVEY.
  5. ASBUILT DATA HAS BEEN SOURCED FROM A COMBINATION OF WOODS SURVEY MEASURED DATA AND CONTRACTOR RECEIVED DATA.

I certify that these As-built Plans are an accurate record of the works undertaken and that:

- The coordinates (X, Y) are in terms of NZTM on NZGD2000
- The Levels (Z) are in terms of One Tree Point 1964 (MSL) LINZ datum

Signed: \_\_\_\_\_ Registered Professional Surveyor

Date: 16/05/2018

Name: \_\_\_\_\_

**LEGEND**

STORMWATER MANHOLE	
STORMWATER CESSPIT	
STORMWATER DOUBLE CESSPIT	
NEW STORMWATER	
LOT CONNECTION	
STAGE BOUNDARY	

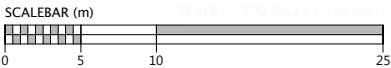

REVISION DETAILS	INT	DATE	SURVEYED	NSC
1 DRAFT ISSUE	NSC	17/05/18	DESIGNED	NSC
			DRAWN	NSC
			CHECKED	MRH
			APPROVED	MRH

ONE TREE POINT ROAD  
ONE TREE POINT  
NORTHLAND

**WFH** PROPERTIES

WOODS.CO.NZ

**THE LANDING @ MARSDEN, ONE TREE POINT**  
STAGES 1-2  
STORMWATER

STATUS	ISSUED FOR INFORMATION	REV
SCALE	1:500 @ A3	1
COUNCIL	WHANGAREI DISTRICT COUNCIL	
DWG NO	31013-01-304-AB	

# DRAFT

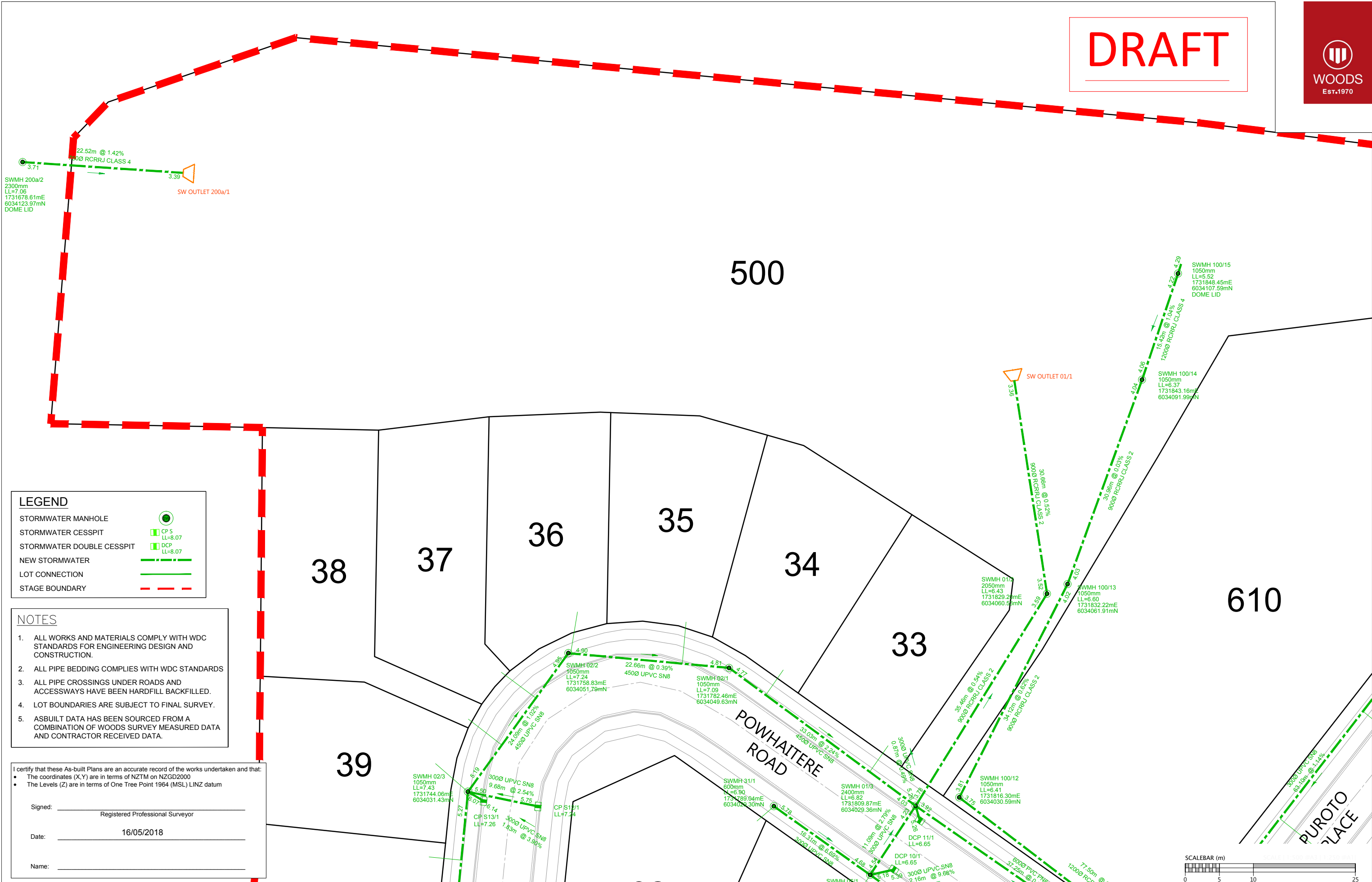

**LEGEND**

STORMWATER MANHOLE	
STORMWATER CESSPIT	
STORMWATER DOUBLE CESSPIT	
NEW STORMWATER	
LOT CONNECTION	
STAGE BOUNDARY	

- NOTES**
- ALL WORKS AND MATERIALS COMPLY WITH WDC STANDARDS FOR ENGINEERING DESIGN AND CONSTRUCTION.
  - ALL PIPE BEDDING COMPLIES WITH WDC STANDARDS
  - ALL PIPE CROSSINGS UNDER ROADS AND ACCESSWAYS HAVE BEEN HARDFILL BACKFILLED.
  - LOT BOUNDARIES ARE SUBJECT TO FINAL SURVEY.
  - ASBUILT DATA HAS BEEN SOURCED FROM A COMBINATION OF WOODS SURVEY MEASURED DATA AND CONTRACTOR RECEIVED DATA.

I certify that these As-built Plans are an accurate record of the works undertaken and that:

- The coordinates (X,Y) are in terms of NZTM on NZGD2000
- The Levels (Z) are in terms of One Tree Point 1964 (MSL) LINZ datum

Signed: \_\_\_\_\_  
Registered Professional Surveyor

Date: 16/05/2018

Name: \_\_\_\_\_

REVISION DETAILS	INT	DATE	SURVEYED	NSC
1 DRAFT ISSUE	NSC	17/05/18	DESIGNED	NSC
			DRAWN	NSC
			CHECKED	MRH
			APPROVED	MRH

ONE TREE POINT ROAD  
ONE TREE POINT  
NORTHLAND



**THE LANDING @ MARSDEN, ONE TREE POINT  
STAGES 1-2  
STORMWATER**

STATUS	ISSUED FOR INFORMATION	REV
SCALE	1:500 @ A3	1
COUNCIL	WHANGAREI DISTRICT COUNCIL	
DWG NO	31013-01-305-AB	

